



Planning Committee A

To be held on 5th October 2023

22/01032/FUL - BHE Self Storage, Self Storage Facility, Lambshill, Towthorpe Moor Lane, Strensall, York

Change of use of agricultural land to the siting of 118 storage containers (use class B8) - retrospective

Site Location Plan

0 12.5 25 37.5 50 62.5m
1:1250

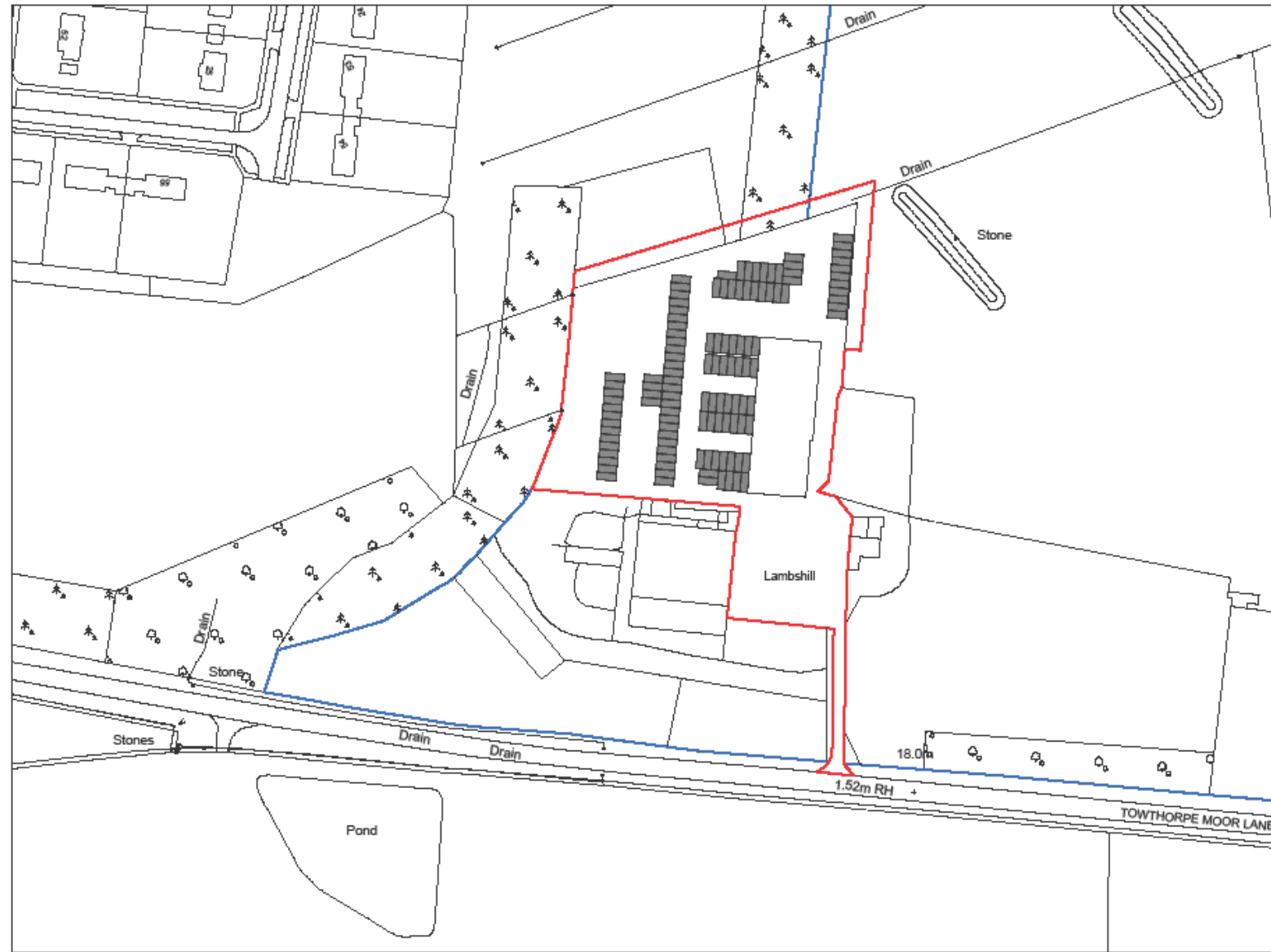

1	Site	Site boundary
2	Drain	Drain
3	Stone	Stone
4	Stones	Stones
5	Pond	Pond

BHE Self Storage

Rétrospective Application for Storage Containers

Lambhill Farm
Towthorpe
Strensall
YO32 9SR

Location Plan

1:1250 @ A3

March 2022

22.3422-01

turton ASSOCIATES

T: +44 (0) 1430 808 815
F: +44 (0) 1430 828 817
info@turtonassociates.co.uk
www.turtonassociates.co.uk

The Wood
High Street
York YO1 1PF



Site Entrance from
Towthorpe Road



Site Entrance and approach to buildings





Containers in situ within building



Containers sited externally

Building Housing Containers



Vehicles being stored at site



Exterior view of Site
from Towthorpe
Road (South)



Exterior View from East



Exterior view from North



Site Layout Plan

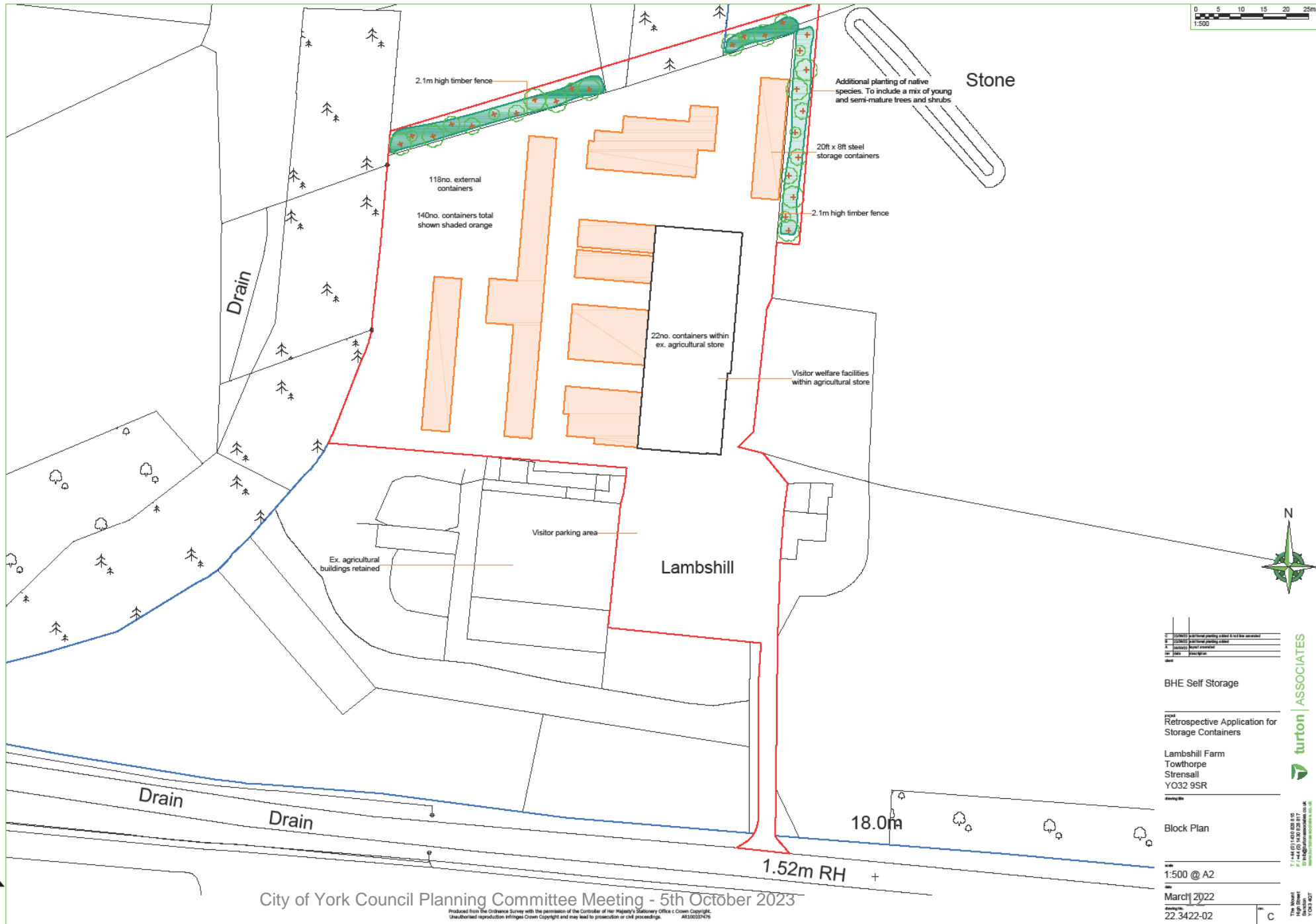

City of York Council Planning Committee Meeting - 5th October 2023

Produced from the Ordnance Survey with the permission of the Controller of Her Majesty's Stationery Office © Crown Copyright. All rights reserved. Unauthorised reproduction infringes Crown Copyright and may lead to prosecution or civil proceedings. AK10055476

15/03/2023	Additional planting of native species
15/03/2023	Additional planting of native species
15/03/2023	Additional planting of native species
15/03/2023	Additional planting of native species
15/03/2023	Additional planting of native species
15/03/2023	Additional planting of native species

BHE Self Storage

Retrospective Application for Storage Containers

Lambshill Farm
Towthorpe
Strensall
YO32 9SR

Block Plan

1:500 @ A2

March 2022

22.3422-02

turton ASSOCIATES
 7 FINE LINE COURT, 1400 BRISTOL ROAD, BIRMINGHAM, B15 2JG
 TEL: 0121 717 1000 FAX: 0121 717 1001
 WWW.TURTONASSOCIATES.CO.UK

